

## Sawmill Operating Procedures during COVID.

Until the sawmill is able to open fully and the public have access to the internal layouts, public access will be restricted as follows: .

1 – Access into the new foyer to view the 0 gauge and G scale layouts in the sawmill, through the new viewing platform, which has been adapted for wheelchair users.

2 – The layouts, of various gauges, in the foyer will be operated by a coin machine, with a view to having “visiting” layouts displayed and static displays of varying era’s on shelving with suspended aircraft above.

3 – To the left of the viewing area will be a display of static models possible boat’s changed at regular intervals to keep the display fresh, with mirror behind enabling viewing from all sides.

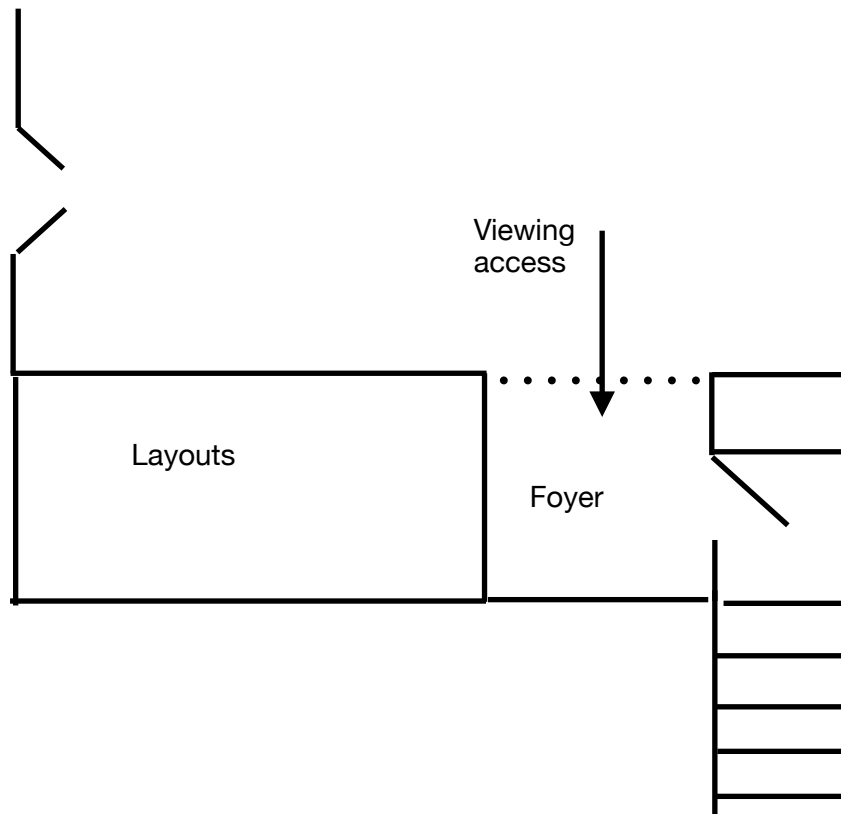

In line with Government Covid Guidelines there is to be no more than six members of MERMS in the sawmill at any one time, face masks must be worn at all times and social distancing adhered to.

The fire door must be unlocked when members are in attendance.

Clean up before leaving and leave tidy.

Switch off all electrics when leaving.

